

WalzCraft®

Drawer Box Installation Supports (Full Extension Undermount Slides for Face Frame Cabinets)

Using the Drawer Box Installation Supports

#171377 Drawer Box Installation Supports

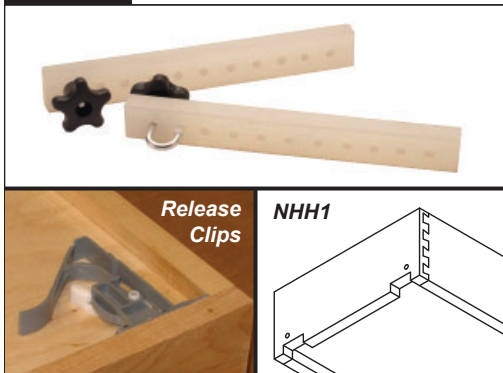

The Drawer Box Installation Supports allow an installer to easily find the correct location to secure the drawer slide rear mounting brackets during the installation of a drawer box.

Note:

- To use the Drawer Box Installation Supports, the drawer box height must be ordered 1" shorter than the opening height.
- Drawer boxes must be ordered to the correct width and length in order for the undermount slides to attach properly to the drawer boxes.
- The drawer boxes also require that an appropriately sized notch and hook combination (NHH1) be cut out of the back of the box.
- Undermount slides also require that a pair of release clips be installed beneath the front corners of the box.

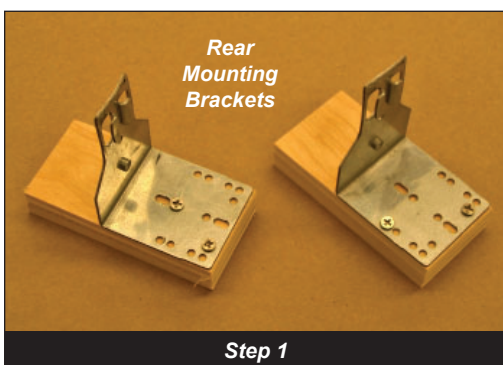

Step 1:

These slides are secured to the back of the cabinet with rear mounting brackets.

Attach each bracket to a ½" or ¾" thick plywood block that is about 2" wide x 4" high.

Use two screws each and mount the brackets flush with the top and left & right edges of the blocks.



Step 2:

Next, attach the slides to the underside of the drawer box and engage them into the release clips.

Then position the rear mounting brackets, which are attached to the blocks, into the channel at the back of the slides with the plywood blocks extending down below the drawer box.



Step 3:

Next, attach the Drawer Box Installation Supports to the front corners of the drawer box.



Continued on next page...

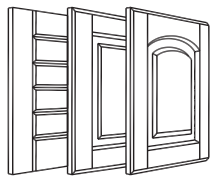

Drawer Box Installation Supports (Full Extension Undermount Slides for Face Frame Cabinets)

Using the Drawer Box Installation Supports...continued



Step 4.

Then carefully work the entire rear of the assembly into the opening so both rear mounting brackets are inside the cabinet.

While supporting the drawer box from the underside, move the box and attached slides all the way back into the cabinet until the front of the slides are flush with the front of the cabinet.

A support tool is ideal for this step.

Then clamp the Box Installation Supports to the adjacent face frame stiles. This will hold the box in the correct final position.

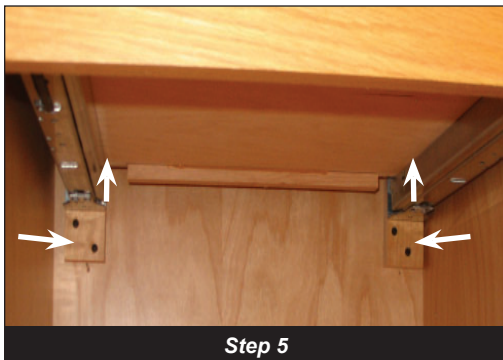

Step 5.

Inside the cabinet, push the slides up tightly against the bottom of the drawer box, and then push the plywood blocks (with attached rear mounting brackets) against the back wall of the cabinet.

Fasten them with several brad nails or two screws each.

Remove the Installation Supports from the front of the drawer, then carefully disconnect the drawer and remove it completely from the opening.



Step 6.

Attach the slides to the face frame stiles with one screw each, setting the front of the slides back about 1/8" from the face of the cabinet.



Step 7.

Re-insert the drawer box, pushing it in until the clips engage.

Finally, pull the drawer back out to check its operation.

All Steps Complete