

Molding Options

Refacing Molding

1/8" Refacing Molding

Drawing not to Scale

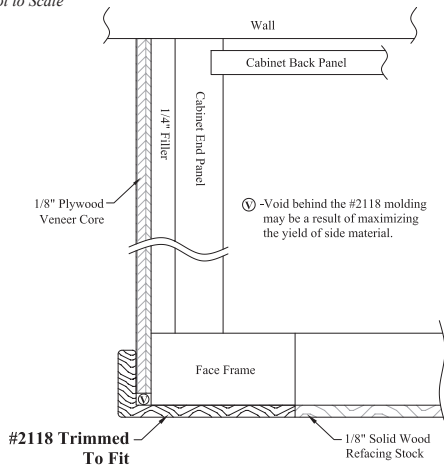

Molding #	Dimension A	Dimension B	Price Class	Square Foot
2115	1 ³ / ₁₆ " [30.2mm]	1" [25.4mm]	M101	.79
2331	1 ⁵ / ₁₆ " [33.3mm]	1 ¹ / ₈ " [28.6mm]	M101	.88
2116	1 ⁷ / ₁₆ " [36.5mm]	1 ¹ / ₄ " [31.8mm]	M101	.96
2332	1 ⁹ / ₁₆ " [39.7mm]	1 ³ / ₈ " [34.9mm]	M101	1.04
2117	1 ¹¹ / ₁₆ " [42.9mm]	1 ¹ / ₂ " [38.1mm]	M101	1.13
2333	1 ¹³ / ₁₆ " [46.0mm]	1 ⁵ / ₈ " [41.3mm]	M101	1.21
2118	1 ¹⁵ / ₁₆ " [49.2mm]	1 ³ / ₄ " [44.5mm]	M101	1.29
2334	2 ¹ / ₁₆ " [52.4mm]	1 ⁷ / ₈ " [47.6mm]	M101	1.38
2119	2 ³ / ₁₆ " [55.6mm]	2" [50.8mm]	M101	1.46
2335	2 ⁵ / ₁₆ " [58.7mm]	2 ¹ / ₈ " [54.0mm]	M101	1.54
2166	2 ⁷ / ₁₆ " [61.9mm]	2 ¹ / ₄ " [57.2mm]	M101	1.63
2336	2 ⁹ / ₁₆ " [65.1mm]	2 ³ / ₈ " [60.3mm]	M101	1.71
2120	2 ¹¹ / ₁₆ " [68.3mm]	2 ¹ / ₂ " [63.5mm]	M101	1.79
2337	2 ¹³ / ₁₆ " [71.4mm]	2 ⁵ / ₈ " [66.7mm]	M101	1.88
2167	2 ¹⁵ / ₁₆ " [74.6mm]	2 ³ / ₄ " [70.0mm]	M101	1.96
2338	3 ¹ / ₁₆ " [77.8mm]	2 ⁷ / ₈ " [73.0mm]	M101	2.04
2168	3 ³ / ₁₆ " [81.0mm]	3" [76.2mm]	M101	2.13
2339	3 ⁵ / ₁₆ " [84.1mm]	3 ¹ / ₈ " [79.4mm]	M101	2.21
2169	3 ⁷ / ₁₆ " [87.3mm]	3 ¹ / ₄ " [82.6mm]	M101	2.29
2340	3 ⁹ / ₁₆ " [90.5mm]	3 ³ / ₈ " [85.7mm]	M101	2.38
2341	3 ¹¹ / ₁₆ " [93.7mm]	3 ¹ / ₂ " [88.9mm]	M101	2.46

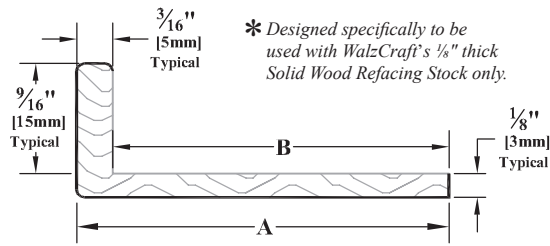

3/16" Refacing Molding

Drawing not to Scale

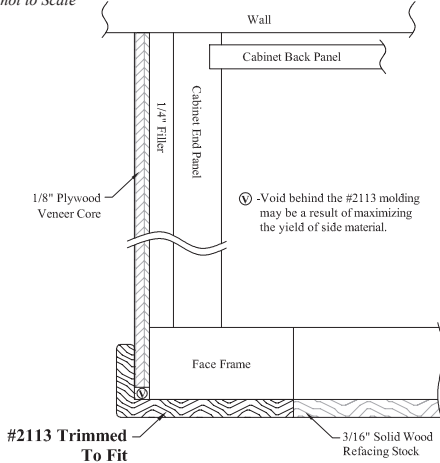

Molding #	Dimension A	Dimension B	Price Class	Square Foot
2145	1 ³ / ₁₆ " [30.2mm]	1" [25.4mm]	M101	.79
2342	1 ⁵ / ₁₆ " [33.3mm]	1 ¹ / ₈ " [28.6mm]	M101	.88
2111	1 ⁷ / ₁₆ " [36.5mm]	1 ¹ / ₄ " [31.8mm]	M101	.96
2343	1 ⁹ / ₁₆ " [39.7mm]	1 ³ / ₈ " [34.9mm]	M101	1.04
2142	1 ¹¹ / ₁₆ " [42.9mm]	1 ¹ / ₂ " [38.1mm]	M101	1.13
2344	1 ¹³ / ₁₆ " [46.0mm]	1 ⁵ / ₈ " [41.3mm]	M101	1.21
2113	1 ¹⁵ / ₁₆ " [49.2mm]	1 ³ / ₄ " [44.5mm]	M101	1.29
2968	2" [50.8mm]	1 ¹³ / ₁₆ " [46.0mm]	M101	1.33
2345	2 ¹ / ₁₆ " [52.4mm]	1 ⁷ / ₈ " [47.6mm]	M101	1.38
2114	2 ³ / ₁₆ " [55.6mm]	2" [50.8mm]	M101	1.46
2346	2 ⁵ / ₁₆ " [58.7mm]	2 ¹ / ₈ " [54.0mm]	M101	1.54
2162	2 ⁷ / ₁₆ " [61.9mm]	2 ¹ / ₄ " [57.2mm]	M101	1.63
2347	2 ⁹ / ₁₆ " [65.1mm]	2 ³ / ₈ " [60.3mm]	M101	1.71
2143	2 ¹¹ / ₁₆ " [68.3mm]	2 ¹ / ₂ " [63.5mm]	M101	1.79
2348	2 ¹³ / ₁₆ " [71.4mm]	2 ⁵ / ₈ " [66.7mm]	M101	1.88
2163	2 ¹⁵ / ₁₆ " [74.6mm]	2 ³ / ₄ " [70.0mm]	M101	1.96
2349	3 ¹ / ₁₆ " [77.8mm]	2 ⁷ / ₈ " [73.0mm]	M101	2.04
2164	3 ³ / ₁₆ " [81.0mm]	3" [76.2mm]	M101	2.13
2350	3 ⁵ / ₁₆ " [84.1mm]	3 ¹ / ₈ " [79.4mm]	M101	2.21
2165	3 ⁷ / ₁₆ " [87.3mm]	3 ¹ / ₄ " [82.6mm]	M101	2.29
2351	3 ⁹ / ₁₆ " [90.5mm]	3 ³ / ₈ " [85.7mm]	M101	2.38
2352	3 ¹¹ / ₁₆ " [93.7mm]	3 ¹ / ₂ " [88.9mm]	M101	2.46

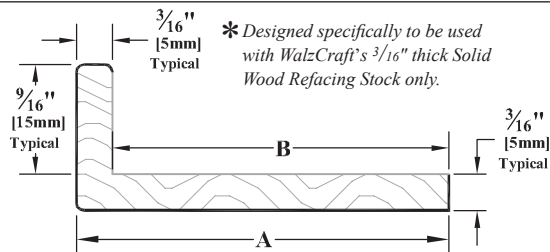

* We can control the finished thickness of the Refacing Moldings and Solid Wood Refacing Stock as they are produced in house. These moldings are not intended to be used with sheet stock (on face of cabinet), as plywood thicknesses are beyond our ability to control.

Miscellaneous Refacing Molding

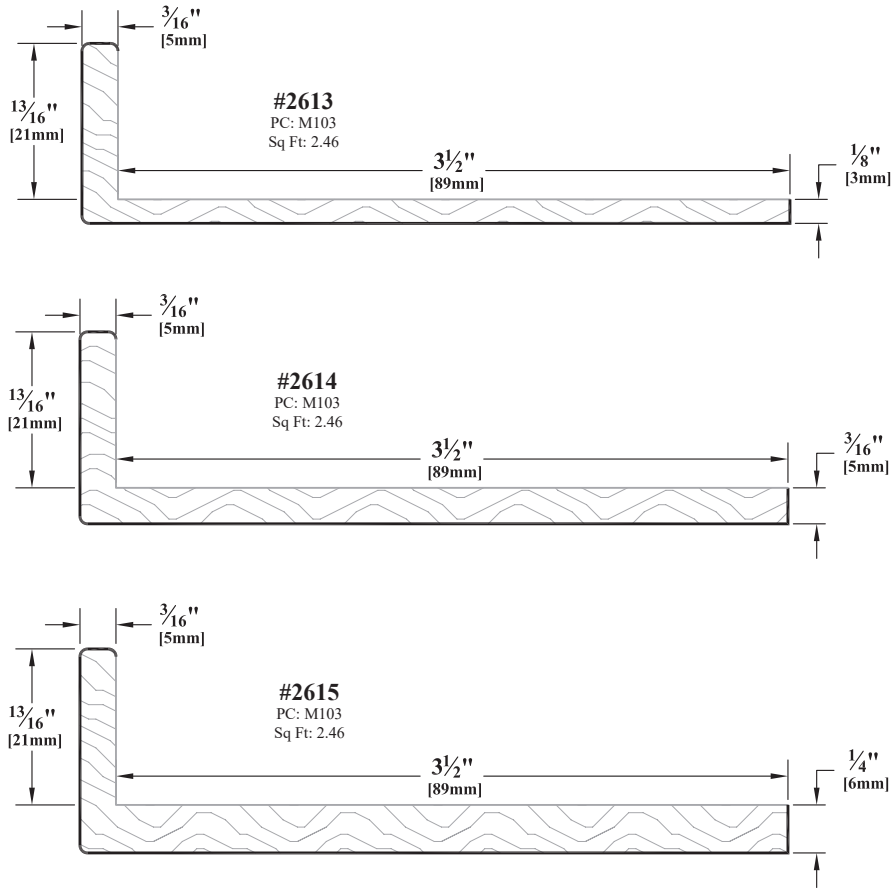

Miscellaneous Refacing Molding...continued

For 1/4" Plywood				For 1/8" Plywood				For Wood Back Veneer	For 1/8" Plywood	For 1/4" Plywood
#2353 PC: M102 Sq Ft: .70	#2354 PC: M102 Sq Ft: .70	#2355 PC: M102 Sq Ft: .79	#2356 PC: M102 Sq Ft: .96	#2101 PC: M102 Sq Ft: .70	#2357 PC: M102 Sq Ft: .70	#2358 PC: M102 Sq Ft: .79	#2359 PC: M102 Sq Ft: .96	#2124 PC: M102 Sq Ft: .70	#870 PC: M102 Sq Ft: .70	#2023 PC: M101 Sq Ft: .70

► For PRICING ► See Section N.2 in our current Wholesale Pricing Catalog.

Molding Options

Refacing Molding

Solid Wood Refacing Stock (RFS100)

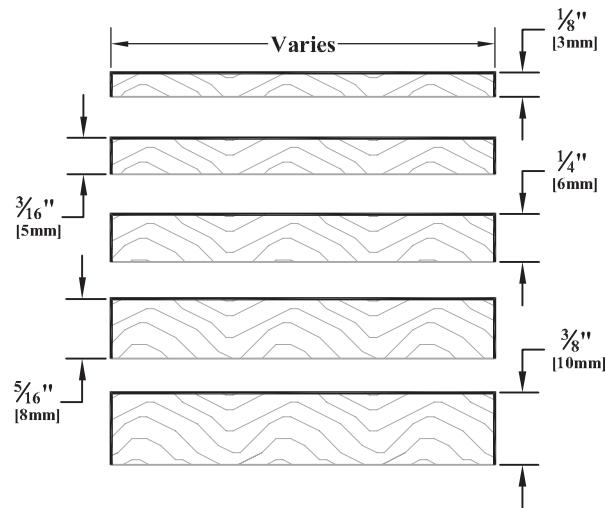

Ordering & Pricing Notes: Solid Wood Refacing Stock (RFS100)

Ordering Guidelines

1	Order Forms	Please use <i>Face Frame Stock Order Form (E-Z Form #9)</i> .
---	-------------	---

Pricing

1	Pricing	Please see <i>Section N.2</i> of our current Wholesale Pricing Catalog .
---	---------	---

Technical Notes: Solid Wood Refacing Stock (RFS100)

Finish Options (Chapter R)

1	Finishing	Solid Wood Refacing Stock will be considered a Two-Sided (2S) finished product. The backs will be sealed while the face and all edges will be sealed and top coated. Please see <i>Finish Section R.3</i> for information on Glazing.
---	-----------	---

General Information (Chapter A)

1	Minimum Order Quantity	No minimum order quantity.
---	------------------------	----------------------------

Molding Options (Chapter N)

1	RFS100	Refacing Stock uses part #RFS100.
---	--------	-----------------------------------

Sizes / Dimensions

1	Thickness - RFS100	Available in 1/8" [3.2mm], 3/16" [4.8mm], 1/4" [6.4mm], 5/16" [7.9mm] and 3/8" [9.5mm] thicknesses.
2	Width - RFS100	Solid Wood Refacing Stock is available in a minimum width of 5/8" [15.9mm] and a maximum width of 6" [152.4mm]. 6" [152.4mm] Maximum Width: WalzCraft makes every attempt to produce these parts from one solid piece of wood. Due to lumber availability and/or wood species, widths under 6" [152.4mm] may need to be made from two or more edge glued pieces. For widths over 6" [152.4mm], please refer to our GUPFS product found in <i>Section M.16</i> .
3	Length - RFS100	Available in 8' [2438.4mm] Lengths, Cut-to-Length and Random Lengths. Random length sizes vary between 36" [914.4mm] and 96" [2438.4mm] long. When measured, we round down to the next nearest 1/2 foot. Minimum quantity of 200 lineal feet. Solid wood refacing stock has a standard length of up to 96" [2438.4mm]. Lengths greater than 8' [2438.4mm] are subject to availability. <i>Please note that the choice of wood species and grade can impact the availability of lengths greater than 8' [2438.4mm].</i> See <i>Section N.12</i> for more information on molding lengths.
4	3D Laminate (RTF)	3D Laminate (RTF) Refacing Stock is made of a solid wood core (Maple - Paint Grade) and is not subject to the same thickness limitations as MDF. Maximum length of 96" [2438.4mm].

Wood Specie Options (Chapter S)

1	Knotty & Rustic Grades	Knotty and Rustic grade materials will only have small knots, if any.
---	------------------------	---

Outside Corner Molding

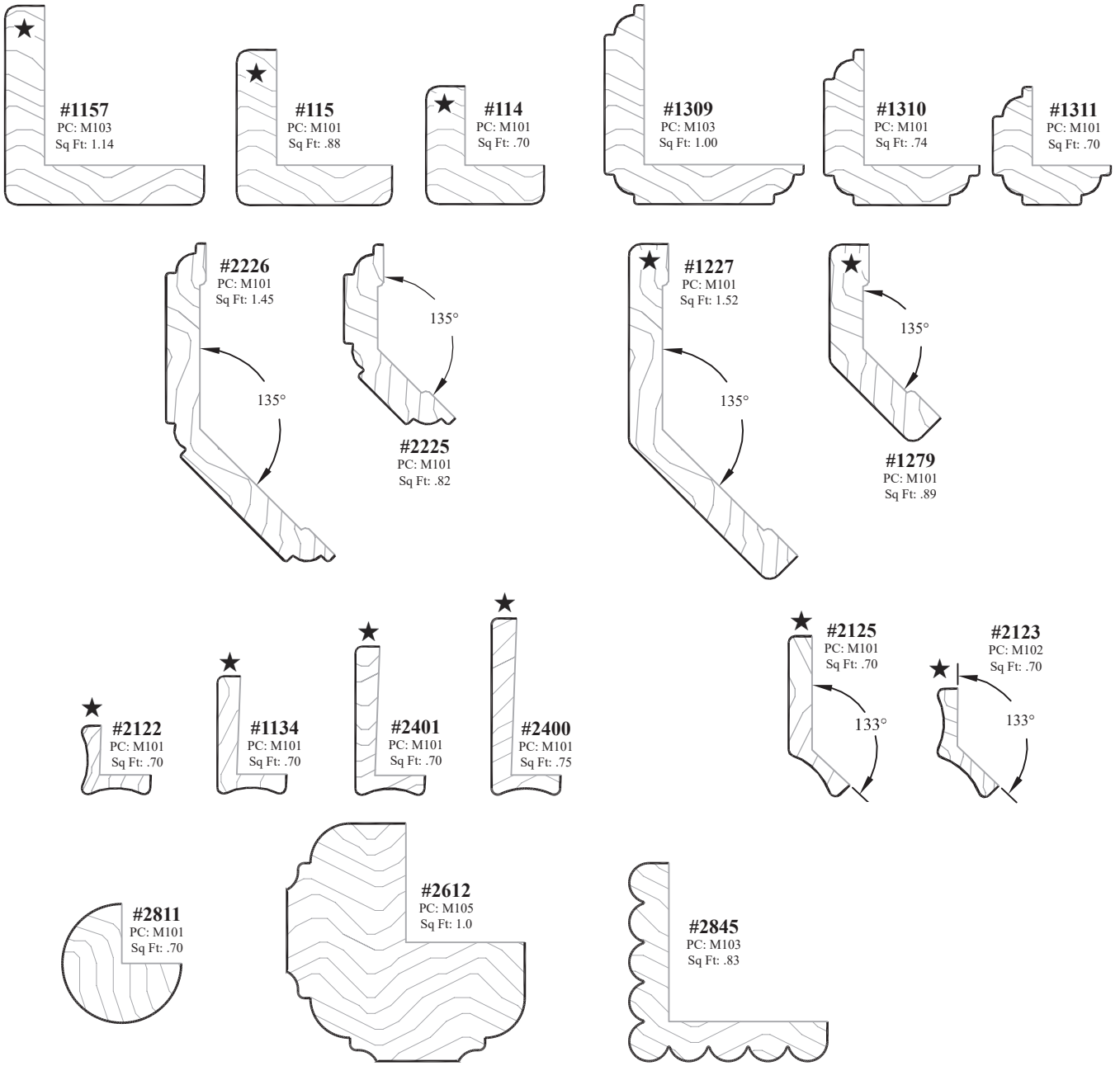

"Inside" Corner Molding

★ **90° Inside Corner**

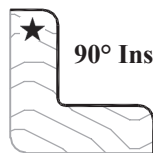

#1651
 PC: M101
 Sq Ft: .70

135° Inside Corner

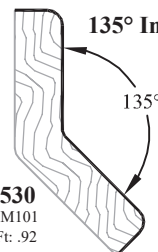

#2530
 PC: M101
 Sq Ft: .92

► For PRICING ► See Section N.3 in our current Wholesale Pricing Catalog.